

**LOCATION**

237 E. IRVING PARK ROAD, UNIT 001  
 STREAMWOOD, IL 60107  
 ± 8,500 SQ-FT



**EXISTING CONSTRUCTION**

**FRONT WALL**  
 ALUM. STOREFRONT ASSEMBLY

**REAR WALL**  
 GYP. BD. FURRING OVER  
 CMU WALL

**SIDE WALLS**  
 GYP. BD. DEMISING WALLS  
 GYP. BD. FURRING OVER  
 CMU WALL

**SALES AREA AND STOCKROOM**  
 OUTLETS (MISC. LOCATIONS)  
 2x4, 1x4 LIGHT FIXTURES  
 WALL FINISH: PAINT W/ VINYL BASE

**OFFICE**  
 OUTLETS (MISC. LOCATIONS)  
 2x4 LIGHT FIXTURES  
 2x4 LAY-IN CEILING TILE & GRID  
 WALL FINISH: GYP. BOARD

**UTILITY**  
 OUTLETS  
 FAN & LIGHT FIXTURE  
 2x4 LAY-IN CEILING TILE & GRID  
 WALL FINISH: C.TILE W/ VINYL BASE  
 200A PANEL: 240V, 3Φ, 4W

**TOILETS**  
 OUTLETS  
 FAN & LIGHT FIXTURE  
 GYP. BOARD CEILING  
 WALL FINISH: GYP. BOARD W/ FRP MAINSCOT

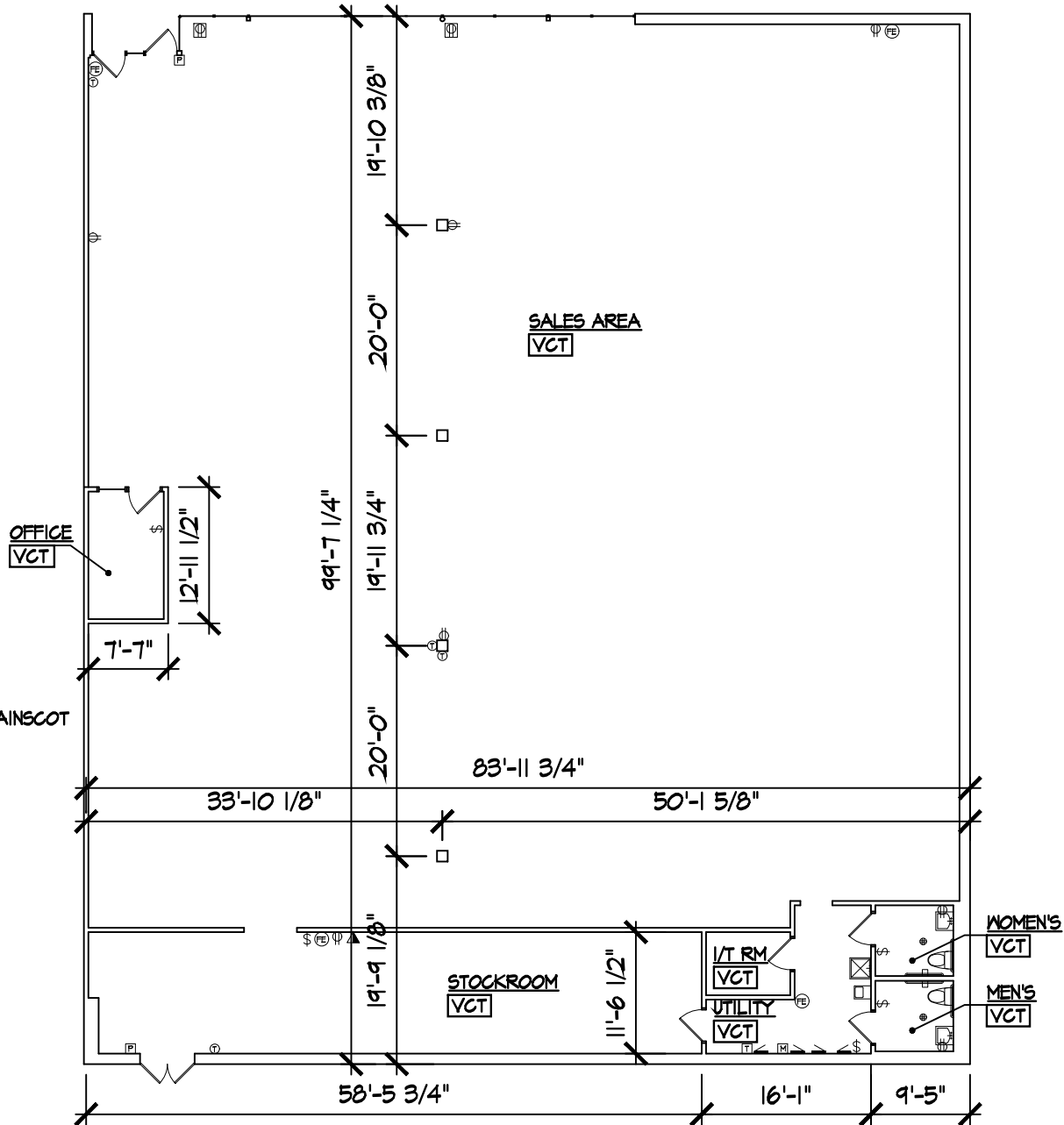

**FLOOR PLAN**

SCALE: 1/16" = 1'-0"



**LEGEND**

⊖	WALL OUTLET	⊖	FLOOR/CLS OUTLET
\$	LIGHT SWITCH	⊕	FLOOR DRAIN
⊠	FIRE ALARM FULL STATION	—	1x4 LINEAR LIGHT FIXTURE
⊕	SPEAKER	⊕	HEAT / SMOKE DETECTOR
△	TRACK LIGHT	⊕	THERMOSTAT
⊠	TOILET EXH. FAN	■	POWER PANEL
⊕	2x4 FLUORESCENT LIGHT FIXTURE	⊠	DIFFUSER / REGISTER
⊕	PENDANT LIGHT FIXTURE	⊠	VISUAL STROBE ALARM SYSTEM
⊠	EXIT SIGN	⊠	AUDIO / VISUAL ALARM SYSTEM
⊠	BATTERY PACK EMERGENCY FIXTURE	*	SPRINKLER
⊕	FIRE EXTINGUISHER	T	TIMER



MARCH 19, 2019

LEASING INQUIRIES  
 PHONE: 877.206.5656  
 EMAIL: LEASING@IRCETAILCENTERS.COM  
 IRCETAILCENTERS.COM