



WOODLAND HEIGHTS
 121 E IRVING PARK RD
 STREAMWOOD, IL 60107
 SQUARE FOOTAGE: 4,850
 UNIT 19

EXISTING CONSTRUCTION

- FRONT: ALUM. STOREFRONT ASSEMBLY (1/4" GLASS)/ GYP. BD. ON MTL. FURRING OVER MASONRY
- SIDES: 1 HR. GYP. BD. DEMISING WALL/GYP. BD. ON MTL. FURRING OVER MASONRY
- REAR: GYP. BD. ON MTL. FURRING OVER MASONRY
- OFFICES:
 - OUTLETS & TELE/DATA (MISC. LOCATIONS)
 - 2x4 RECESSED FLUORESCENT FIXTURES
 - 2x4 CEILING TILE & GRID
 - FINISHES: PAINT, WD CHAIR & CROWN CARPET BASE
- TOILET (PRE-2010 ADA):
 - COMBO LIGHT / EXHAUST FAN
 - 2x4 CEILING TILE & GRID
 - LAVATORY
 - WATER CLOSET
 - FINISHES: PAINT & VINYL BASE
- ELECTRICAL
 - 200A 120/208V, 3Ø 4W 42 BRKR PANEL
- WATER SERVICE 3/4"Ø

LEGEND

	FLUORESCENT LIGHT FIXTURE		SPRINKLER HEAD
	BATTERY PACK EMERGENCY FIXTURE		THERMOSTAT
	EXIT SIGN		POWER PANEL
	TOILET EXHAUST FAN		DIFFUSER / REGISTER
	DOWNLIGHT FIXTURE		F.A. DEVICES

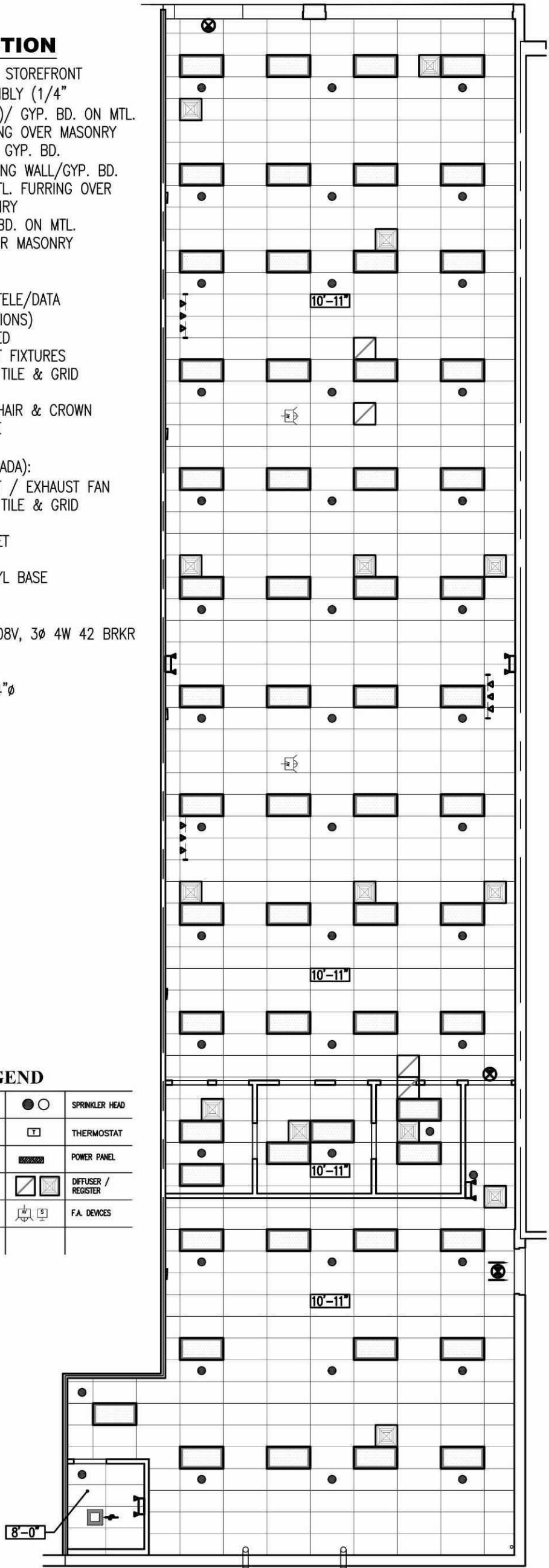

CEILING PLAN
 SCALE: 3/32" = 1'-0"

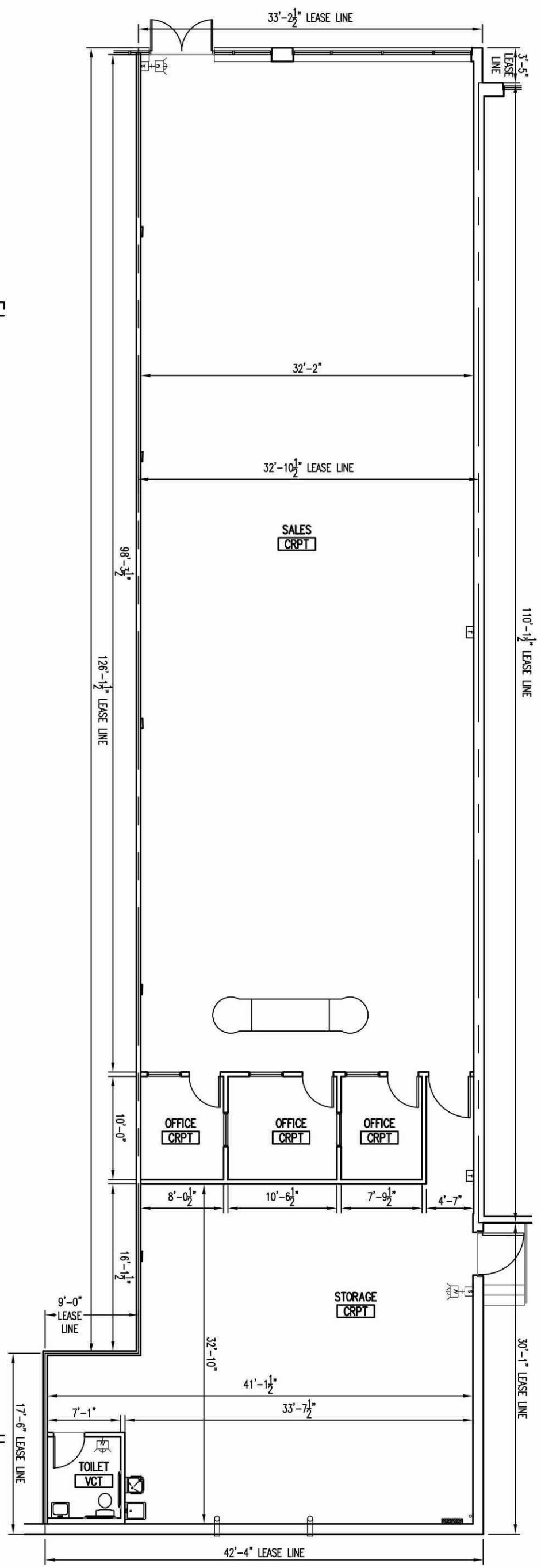

FLOOR PLAN
 SCALE: 3/32" = 1'-0"

