

FLOOR PLAN KEY NOTES:

- ① 225A 120/208V ELEC. PANEL
- ② WATER HEATER ABOVE RESTROOM CEILING
- ③ EXPOSED CMU WALL
- ④ ALUM. FRAMED STOREFRONT SYSTEM w/ 1/4" TH. CLEAR GLAZING
- ⑤ LINE OF CANOPY OVERHEAD
- ⑥ GYPSUM DEMISING WALL
- ⑦ BANK OF GAS METERS
- ⑧ BANK OF ELECTRIC METERS
- ⑨ ASPHALT DRIVE
- ⑩ CONCRETE SIDEWALK
- ⑪ ELECTRIC TRANSFORMER
- ⑫ WATER METER
- ⑬ CONCRETE CURB

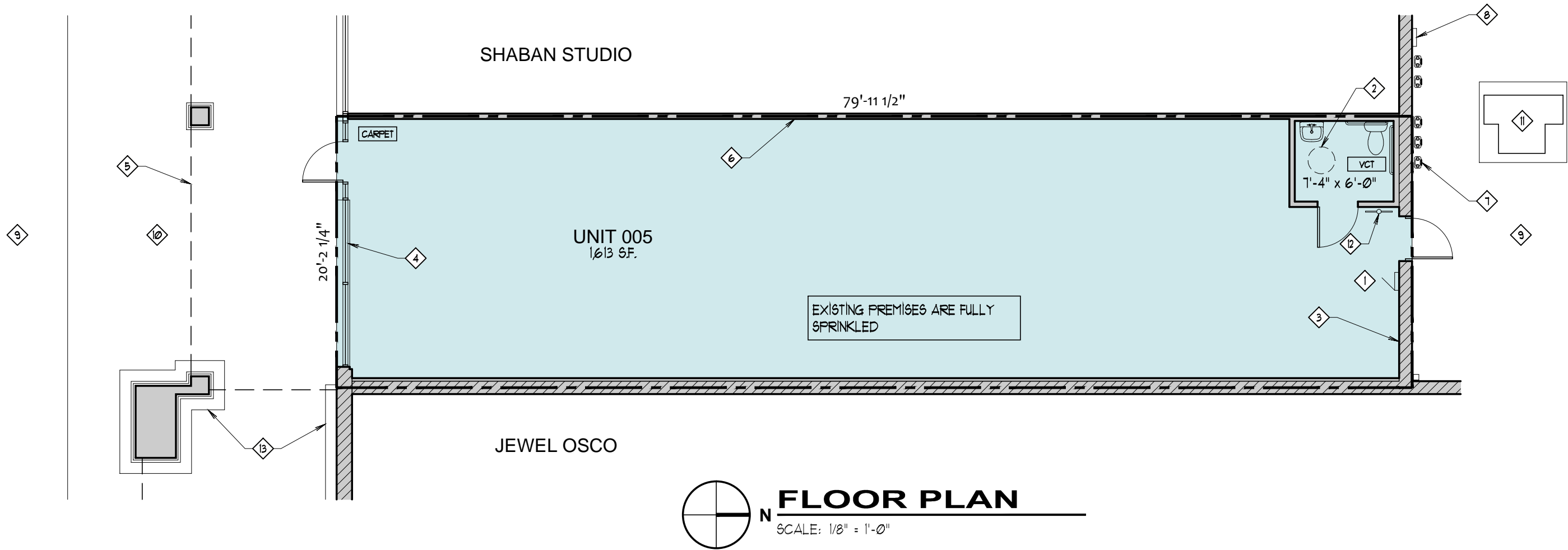

As-Built Plans - Unit 005

Shoppes at Mill Creek  
9654 W. 131st Street - Palos Park, IL 60464

01/14/2019



charles vincent george  
ARCHITECTS

1245 E. Diehl Rd. Suite 101 • Naperville, IL 60563  
P: 630.357.2023 • F: 630.357.2662