

LOCATION

16036 S. HARLEM AVE.,
TINLEY PARK, IL. 60477
GROSS S.F. : 3,125

EXISTING CONSTRUCTION

FRONT WALL
ALUM. STOREFRONT ASSEMBLY

REAR WALL
CMU WALL

SIDE WALLS
GYP. BD. DEMISING WALLS

SALES AREA
OUTLETS (MISC. LOCATIONS)
1x2 AND 2x4 LIGHT FIXTURES
2x4 LAY-IN CEILING TILE & GRID
WALL FINISH: PAINT

STORAGE
OUTLETS (MISC. LOCATIONS)
1x4 LIGHT FIXTURES
2x4 LAY-IN CEILING TILE & GRID
WALL FINISH: PAINT

TOILETS
OUTLETS (MISC. LOCATIONS)
FAN AND LIGHT FIXTURE
GYP. BD. CEILING
WALL FINISH: PAINT W/ FRP MAINSCOT

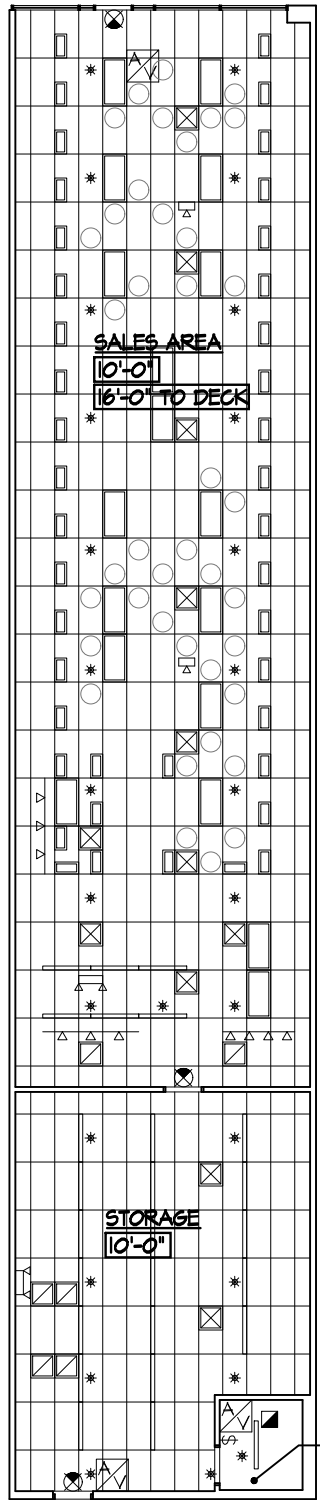

CEILING PLAN
SCALE: 1/16" = 1'-0"

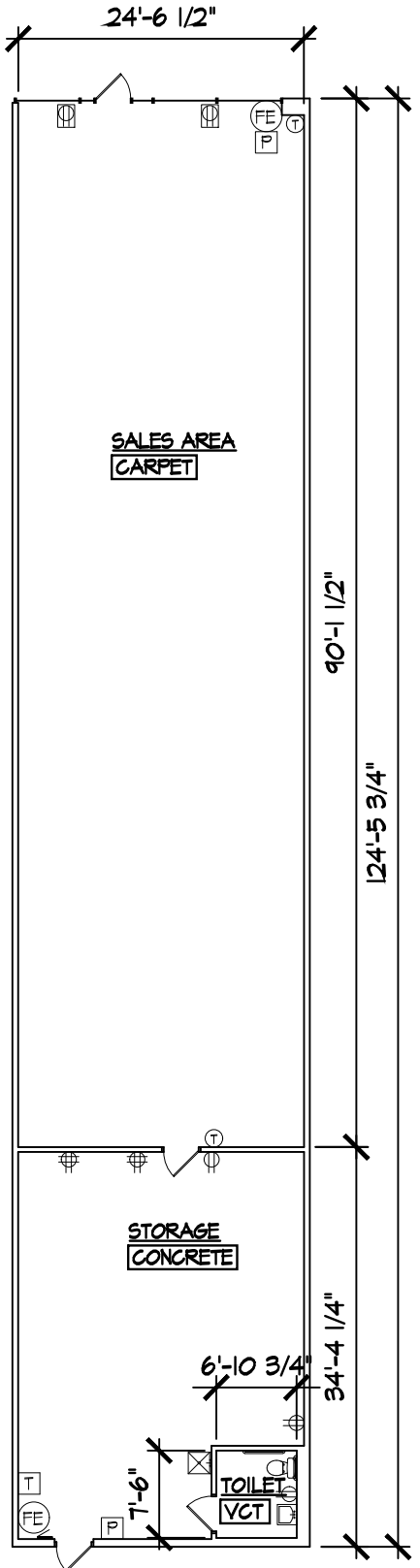

FLOOR PLAN
SCALE: 1/16" = 1'-0"

LEGEND

	WALL OUTLET		FLOOR/CLS OUTLET
	LIGHT SWITCH		FLOOR DRAIN
	FIRE ALARM PULL STATION		1x4 LINEAR LIGHT FIXTURE
	SPEAKER		HEAT / SMOKE DETECTOR
	TRACK LIGHT		SECURITY CAMERA
	TOILET EXH. FAN		THERMOSTAT
	2x4 FLUORESCENT LIGHT FIXTURE		POWER PANEL
	PENDANT LIGHT FIXTURE		DIFFUSER / REGISTER
	EXIT SIGN		AUDIO / VISUAL ALARM SYSTEM
	BATTERY PACK EMERGENCY FIXTURE		SPRINKLER
	FIRE EXTINGUISHER		TIMER

GRAPHIC SCALE
0 3 6 12
DECEMBER 7, 2018