

**WOODLAND HEIGHTS**  
 233 IRVING PARK RD  
 STREAMWOOD, IL 60107  
 SQUARE FOOTAGE: 1,050

**EXISTING CONSTRUCTION**

FRONT: ALUM. STOREFRONT ASSEMBLY (1/4" GLASS)  
 SIDES: 1 HR. GYP. BD. DEMISING WALL  
 REAR: GYP. BD. OVER FURRING OVER MASONRY

SALES/WORK:  
 OUTLETS & TELE/DATA (MISC. LOCATIONS)  
 1x8 SURFACE MOUNTED FLUORESCENT FIXTURES  
 TEXTURE CEILING  
 FINISHES:  
 PAINT, VINYL BASE

TOILET (NON-ADA):  
 GYP. BD. CEILING  
 LAVATORY  
 WATER CLOSET  
 SURFACE MTD.  
 INCANDESCENT LIGHT  
 FINISHES:  
 PAINT & VINYL BASE  
 100 GAL. GAS WATER HEATER

ELECTRICAL  
 200A 120/240V, 1Ø  
 3W 3Ø BRKR PANEL  
 200A 120/240V DISCONNECT  
 100A 120/240V, 1Ø 3W 24 CIRCUIT SUB-PANEL

WATER SERVICE 3/4"Ø

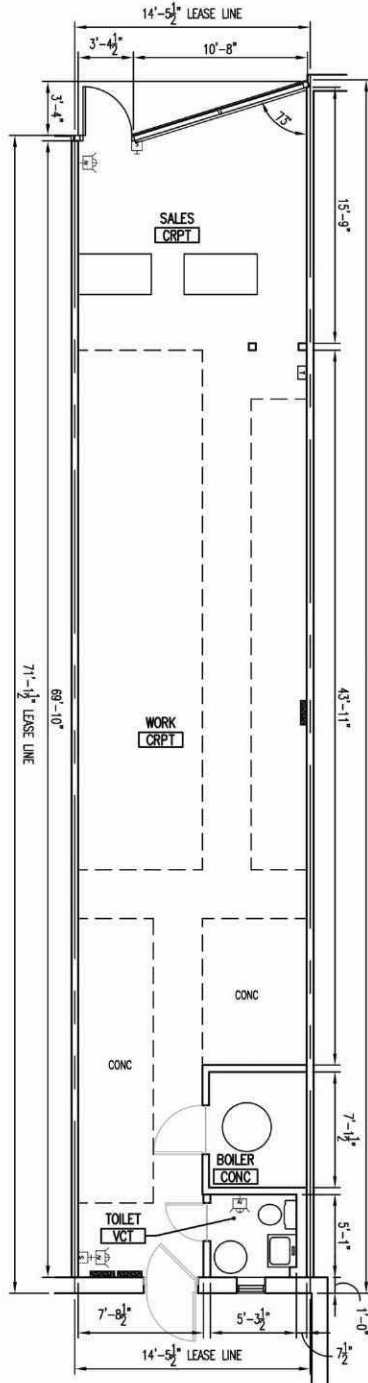

**FLOOR PLAN**  
 SCALE: 1/8" = 1'-0"

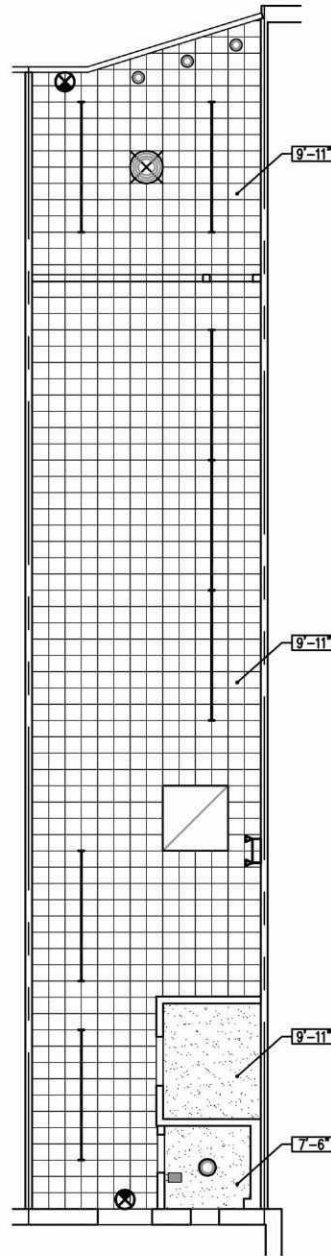

**CEILING PLAN**  
 SCALE: 1/8" = 1'-0"

**LEGEND**

	DOWNLIGHT FIXTURE		FLUORESCENT STRIP FIXTURE
	BATTERY PACK EMERGENCY FIXTURE		THERMOSTAT
	EXIT SIGN		POWER PANEL
	F.A. DEVICES		DIFFUSER / REGISTER



LEASE LINE PER BOMA Z65.5-2010

**LEASING INQUIRIES**  
 PHONE: 877.206.5656  
 EMAIL: LEASING@IRCRETAILCENTERS.COM  
 IRCRETAILCENTERS.COM