

CATON CROSSING
 2302-A IL 59
 PLAINFIELD, IL 60586
 SQUARE FOOTAGE: 3,000
 UNIT 2

EXISTING CONDITIONS

FRONT:
 STOREFRONT ASSEMBLY 1/4" GLAZING
 EXPOSED MASONRY
 DEMISING WALLS:
 1 HR RATED GYP. BOARD ON METAL
 FRAMING / GYPSUM BOARD ON MTL.
 FRAMING OVER CMU
 REAR:
 PAINTED CMU

TANNING BOOTHS/TOILET:
 FLOORS: WD, CT & VCT
 CEILINGS: 2x4 TILE & GRID - BLACK
 (12'-0" AFF)
 GYP. BD. CEILING (8'-0" AFF)
 WALLS: PAINT & CT (TOILET)
 BASE: WD

EXISTING SYSTEMS

ELECTRICAL:
 200A 120/208V, 3Ø 4W 42 CIRCUIT PANEL
 POWER & DATA OUTLETS
 2x4 RECESSED FLUORESCENT & TRACK
 LIGHTS
 HVAC: ROOFTOP UNIT
 WATER SERVICE: 3/4"Ø
 SPRINKLER SERVICE

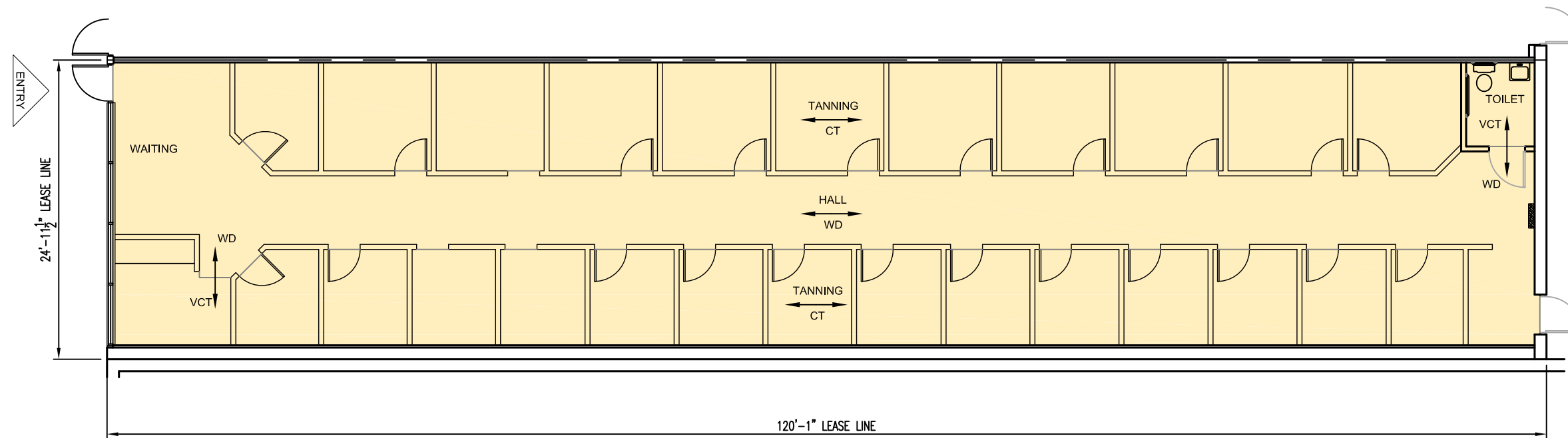

FLOOR PLAN

SCALE: 3/32" = 1'-0"



GRAPHIC SCALE



JUNE 25, 2017
W.O. #1000539