

WOODLAND HEIGHTS
 121 E IRVING PARK RD
 STREAMWOOD, IL 60107
 SQUARE FOOTAGE: **4,850**
UNIT 19

EXISTING CONDITIONS

FRONT:
 STOREFRONT ASSEMBLY 1/4" GLAZING
 GYPSUM BOARD ON MTL. FRAMING/MASONRY
 DEMISING WALLS:
 1 HR RATED GYP. BOARD ON METAL
 FRAMING
REAR:
 GYPSUM BOARD ON MTL. FRAMING OVER
 CMU

SALES/STORAGE/OFFICES/TOILETS:
FLOORS: CARPET & VCT
CEILINGS: 2x4 TILE & GRID
WALLS: PAINT
BASE: VINYL & CARPET

EXISTING SYSTEMS

ELECTRICAL:
 200A 120/208V, 3Ø 4W 42 CIRCUIT PANEL
 POWER & DATA OUTLETS
 2x4 RECESSED FLUORESCENT & TRACK
 LIGHTS
HVAC: ROOFTOP UNITS
WATER SERVICE: 3/4"Ø
SPRINKLER SERVICE

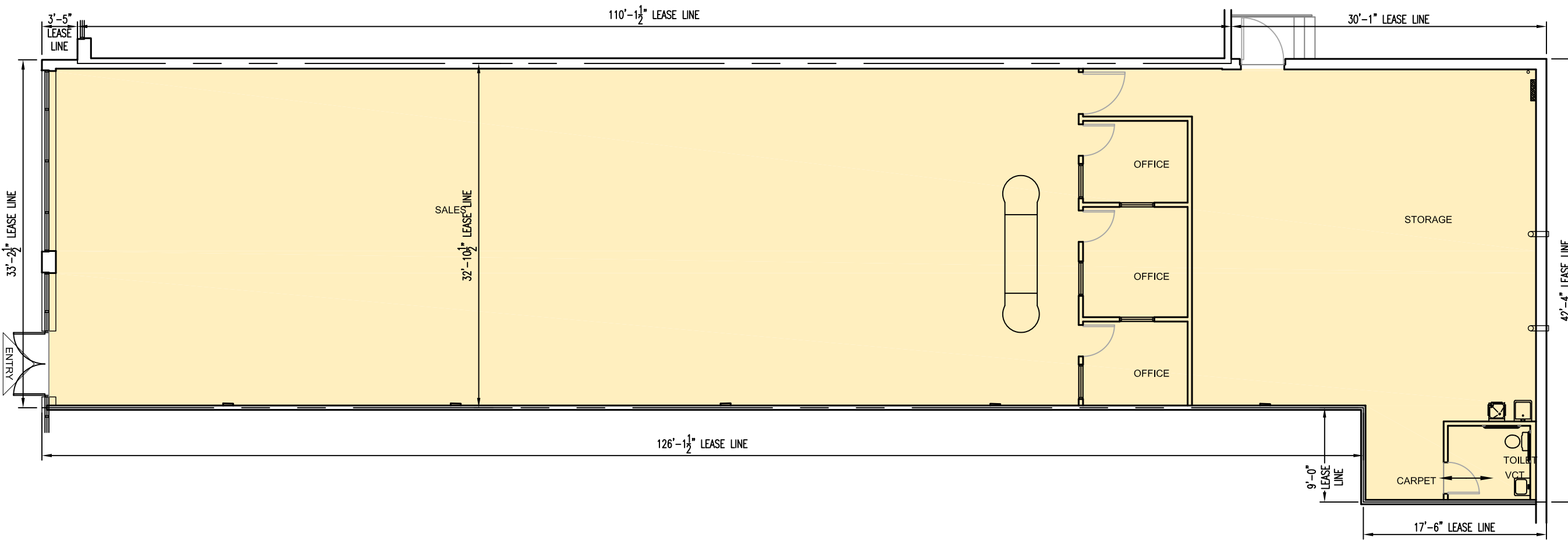

FLOOR PLAN
 SCALE: 3/32" = 1'-0" 



MAY 10, 2017
W.O. #991154